

Houston Area GISday



Thursday, November 16, 2023

9am to 4:30pm CST



2023 Event Guide

General Attendees

University of Houston-Clear Lake - Bayou Building
2700 Bay Area Blvd, Houston, Texas 77058



Thursday, November 16, 2023

9am to 4:30pm CST

Welcome

Dear Attendees,

It is with great excitement and enthusiasm that we welcome you to the Houston Area GIS Day event. Whether you're a seasoned GIS professional, a passionate job seeker seeking your place in the geospatial realm, or a college student eager to explore the vast opportunities in the world of GIS, this event is crafted with you in mind.

Houston Area GIS Day has always been about fostering collaboration, celebrating achievements, and igniting the spark of geospatial innovation. Today, we extend this tradition to a diverse audience of professionals, seekers, and students who share a common interest - a fascination with the power of spatial data.

The activities, presentations, and hands-on sessions you'll experience today are designed to provide a holistic view of the dynamic GIS landscape. Here, you'll have the opportunity to engage with like-minded individuals, learn from experts in the field, and explore how GIS technology can create a more connected and informed world.

Whether you're a GIS veteran looking to stay up-to-date with the latest trends, a job seeker eager to connect with potential employers, or a student ready to dive into the world of geospatial technologies, Houston Area GIS Day is a platform that caters to your unique aspirations.

We encourage you to make the most of this day - connect with peers, expand your knowledge, and fuel your passion for GIS. For our students, this event could spark a lifelong interest and perhaps even shape your future career. For professionals and job seekers, this is an opportunity to build connections, gain insights, and explore career prospects.

On behalf of the Houston Area GIS Day Planning Committee, our generous sponsors, and the geospatial community, we want to express our sincere gratitude for your participation. We've worked diligently to create an event that informs, inspires, and, above all, celebrates the remarkable world of GIS.

So, open this guide, navigate through the sessions and activities, and be prepared to explore, learn, and connect. Welcome to a day filled with GIS innovation and exploration.

Let the journey begin!

University of Houston-Clear Lake - Bayou Building
2700 Bay Area Blvd, Houston, Texas 77058

Schedule

To ensure you make the most of your time here, we've outlined the schedule for the day's events.

Time	Sessions
8:30am	Registration
9:00am	Welcome & Morning Keynote
10:00am	Session 1
10:30am	Session 2
11:00am	Session 3
11:30am	Session 4
12:05pm	Lunch
1:30pm	Reconvene & Afternoon Keynote Onsite Registration Closes
2:30pm	Session 5 Professional Headshot Registration Opens
2:55pm	Session 6
3:20pm	Session 7
3:45pm	Closing & Award Ceremony

Session List

Time		Location	Title	Presenter
9:00am	Welcome	Theater 2nd Floor	Welcome Message	UHCL, H-GAC, and HAGD Planning Committee
9:10am	Keynote	Theater 2nd Floor	GIS in Resilience	Dr. David Retchless
10:00am	Session 1	Garden Room	Data Stewardship in Public Utilities	David McClennen
		Forest Room	City GIS Modernization by Applying GEO AI and Location Intelligence	Vattem Narendra Babu
		Lab 3606 3rd Floor	Survey123, Part 1	Joseph "Brig" Bowles
10:30am	Session 2	Garden Room	Innovation in AEC GIS	Sean Henry
		Forest Room	Houston-Galveston Area Council Geospatial Services & Products	Pramod Sambidi & Jochen Floesser
		Lab 3606 3rd Floor	Survey123, Part 2	Joseph "Brig" Bowles
11:00am	Session 3	Garden Room	How to talk "GIS" to non-GIS	Nicholas Humphrey
		Forest Room	Institutionally Owned Single Family Homes in Fort Bend County	Soma Chatterjee & Emily Moore
		Lab 3606 3rd Floor	Introduction to ArcGIS Reality, Part 1	Joseph "Brig" Bowles

University of Houston-Clear Lake - Bayou Building
2700 Bay Area Blvd, Houston, Texas 77058

Session List (continued)

11:30am	Session 4	Garden Room	How to talk GIS & CAD: Let's get along y'all!	Courtney Roe
		Forest Room	Esri Certification Program	Tamara Adamson
		Lab 3606 3rd Floor	Introduction to ArcGIS Reality, Part 2	Joseph "Brig" Bowles
12:00pm			Lunch & Student Awards	UHCL and HAGD Planning Committee
1:30pm	Welcome	Atrium II	Reconvene	Dr. Jeff Lash
1:40pm	Keynote	Atrium II	National Water Model	Dr. David Maidment
2:30pm	Session 5	Garden Room	How to Obtain a Remote Pilot License	Michael Clanahan
		Forest Room	Appraisal District GIS and Collaboration with Local Government Jurisdictions, Part 1	David Dignum & Joshua Dye
		Lab 3606 3rd Floor	Creating Maps on the Fly with the Census Bureau's Data Hub	Anna Arredondo
		Atrium I	Professional Headshot Registration Opens	HAGD Planning Committee

Session List (continued)

2:55pm	Session 6	Garden Room	Experience Builder: Migrating from WebApp Builder, Part 1	Anna Gonzalez
		Forest Room	Appraisal District GIS and Collaboration with Local Government Jurisdictions, Part 2	David Dignum & Joshua Dye
		Lab 3606 3rd Floor	Census Bureau's Gridded Data Initiative	Anna Arredondo
3:20pm	Session 7	Garden Room	Experience Builder: Migrating from WebApp Builder, Part 2	Anna Gonzalez
		Forest Room	Appraisal District GIS and Collaboration with Local Government Jurisdictions, Part 3	David Dignum & Joshua Dye
		Lab 3606 3rd Floor	Creating Maps on the Fly with the Census Bureau's Data Hub	Anna Arredondo
		Atrium I	Professional Headshot Registration Closes	HAGD Planning Committee
3:45pm	Closing	Atrium II	Award Ceremony & Closing	UHCL, H-GAC, and HAGD Planning Committee

Keynote Speakers



Morning Keynote Speaker - Dr. David Retchless:

Dr. David Retchless is a distinguished expert in the field of Geographic Information Systems (GIS). He serves as a professor at Texas A&M University at Galveston, where he imparts his extensive knowledge in GIS to aspiring professionals. With a career spanning several decades, Dr. Retchless has been at the forefront of GIS applications for disaster resilience, offering invaluable insights into leveraging geospatial technology to address complex challenges. His keynote presentation, "GIS for Disaster Resilience," promises to provide a comprehensive perspective on the transformative power of GIS in ensuring communities' preparedness and resilience in the face of adversity.



Afternoon Keynote Speaker - Dr. David R. Maidment:

Dr. David R. Maidment is a prominent figure in the world of Geographic Information Science. As a distinguished professor at the University of Texas, his contributions to GIS, hydrology, and water resources are highly regarded. With a focus on the National Water Model, Dr. Maidment's expertise brings an in-depth understanding of how geospatial data plays a pivotal role in water resource management. His afternoon keynote presentation will delve into the intricacies of the National Water Model and the revolutionary changes it introduces to water resource planning, offering attendees a remarkable glimpse into the future of hydrology and GIS.

**University of Houston-Clear Lake - Bayou Building
2700 Bay Area Blvd, Houston, Texas 77058**

Presenter Information

Name		Title	Organization
Tamara	Adamson	Training Consultant	Esri
Ana	Arredondo	Data Dissemination Specialist	U.S. Census Bureau
Joseph "Brig"	Bowles	Solution Engineer	Esri
Soma	Chatterjee	GIS Specialist	City of Sugar Land
Michael	Clanahan	UAV Training/Support	AllTerra Central Inc.
David	Dignum	GIS Director	Harris Central Appraisal District
Joshua	Dye	GIS Analyst III	Harris Central Appraisal District
Jochen	Floesser	GIS Director	Houston-Galveston Area Council
Anna	Gonzalez	Solution Engineer	Esri
Sean	Henry	Corporate GIS Manager	Bechtel Corporation
Dr. Jeff	Lash	Professor	University of Houston Clear Lake
David	McClennen	GIS Coordinator	City of Seabrook
Emily	Moore	Community Development Coordinator	City of Sugar Land
Vattem	Narendra Babu	CEO	iSpatial Techno Solutions Inc.
Courtney	Roe	Civil CAD Designer	Pape-Dawson Engineers
Pramod	Sambidi	Assistant Director of Analytics & Research	Houston-Galveston Area Council

University of Houston-Clear Lake - Bayou Building
2700 Bay Area Blvd, Houston, Texas 77058

Outdoor Exhibits and Displays

Extend your GIS experience beyond the conference rooms! Step outside to explore cutting-edge technology and real-world applications in our outdoor display areas.

1. Emergency Vehicles Showcase

Location: Parking Lot D2 Curb (by the bus stop)

Get up close and personal with emergency vehicles from the City of Texas City and Houston METRO. Explore the technology that helps these crucial services navigate and respond effectively.

2. Discovery Bus by Houston METRO

Location: Parking Lot D2 Curb (by the bus stop)

Don't miss the Houston METRO Discovery Bus! Discover how GIS plays a vital role in public transportation and explore the interactive exhibits on board.

3. Drone Display in UHCL Alumni Plaza

Location: UHCL Alumni Plaza

Marvel at the future of aerial data collection! Join licensed drone pilots from AllTerra Central, City of Texas City, and Houston METRO to see their drone technology and equipment. Learn about the applications of drones in GIS and gain insights into this rapidly advancing technology.

Take a stroll through these outdoor exhibits and witness GIS in action in the real world.

Networking Opportunities

We understand that networking is an integral part of your professional growth, and we've designed Houston Area GIS Day to offer plenty of opportunities to connect with your peers and colleagues. Here's how you can make the most of these networking opportunities:

1. Lunch Networking

During our lunch break, from 12:00 PM to 1:30 PM, we encourage you to join your fellow attendees at one of the local dining options available in the area. This is an excellent opportunity to have meaningful conversations, share experiences, and build lasting connections with other professionals in the geospatial field. We've included a list of nearby restaurants in your Event Guide to make the choice even easier.

2. Mappy Hour by URISA Texas

After an engaging day of learning and networking, we invite you to continue the conversation and make new connections at the Mappy Hour hosted by URISA Texas. This casual networking event will take place from 4:00 PM to 7:00 PM, providing you with a relaxed environment to connect with GIS professionals from across the region.

Mappy Hour Details:

Date: Thursday, November 16th

Time: 4:00 PM - 7:00 PM

Location: <https://urisatexas.org/event-5432408>

Special Note: Mappy Hour is graciously sponsored by URISA Texas, and we are grateful for their support.

Don't miss this chance to unwind and forge new professional relationships in a laid-back setting. Join us for Mappy Hour and keep those meaningful conversations going!

**University of Houston-Clear Lake - Bayou Building
2700 Bay Area Blvd, Houston, Texas 77058**



Complimentary Headshot Photoshoot

Are you a GIS professional looking to update your LinkedIn profile or professional portfolio? Or perhaps you're a GIS job seeker aiming to make a lasting impression with potential employers. We've got you covered!

During Sessions 5 and 6, we're excited to offer you a **FREE** opportunity to get a professional headshot taken.

Headshot Photoshoot Details:

Time: Sessions 5 & 6 (2:30 PM - 3:30 PM)

Location: Atrium I

Simply head to Atrium I after the afternoon keynote when Session 5 starts at 2:30 PM, and our photographer will be ready to capture your best angles, ensuring you leave with a high-quality headshot that you can use for all your professional needs.

Don't miss this chance to put your best face forward. Your next job opportunity, networking connection, or professional milestone could be just one great headshot away. Make the most of this exclusive opportunity at Houston Area GIS Day.

**University of Houston-Clear Lake - Bayou Building
2700 Bay Area Blvd, Houston, Texas 77058**

Event Policies

To ensure a smooth and enjoyable experience for all attendees, please take note of the following event policies:

1. Photography and Recording

Photography and recording of the event are generally permitted, but we kindly request that you respect presenters' wishes. If a presenter indicates that photography or recording is not allowed during their session, please adhere to their request. When capturing moments or insights from the event, we encourage you to share your photos and thoughts on social media. Don't forget to acknowledge the presenter and tag us on social media platforms with the hashtags #HoustonAreaGISDay and #GISDay.

2. Respect and Inclusivity

As a professional event, we expect all attendees to maintain a respectful and inclusive environment. Please be considerate of your fellow participants, regardless of their background, experience level, or affiliations. Engage in conversations, debates, and interactions that contribute positively to the event's atmosphere.

3. Campus Rules and Regulations

The University of Houston-Clear Lake (UHCL) is our gracious host for Houston Area GIS Day. As visitors on their campus, we kindly ask that all attendees adhere to UHCL's rules and regulations. This includes guidelines regarding parking, facilities usage, and conduct on campus. Your cooperation ensures a positive and lasting partnership with our hosting institution.

We appreciate your understanding and cooperation in making Houston Area GIS Day a welcoming and respectful event for all participants. Thank you for helping us maintain a productive and harmonious atmosphere during our time at UHCL.

Learn more about UHCL Policies, Standards and Guidelines by visiting their website at www.uhcl.edu/policies/.

Directions

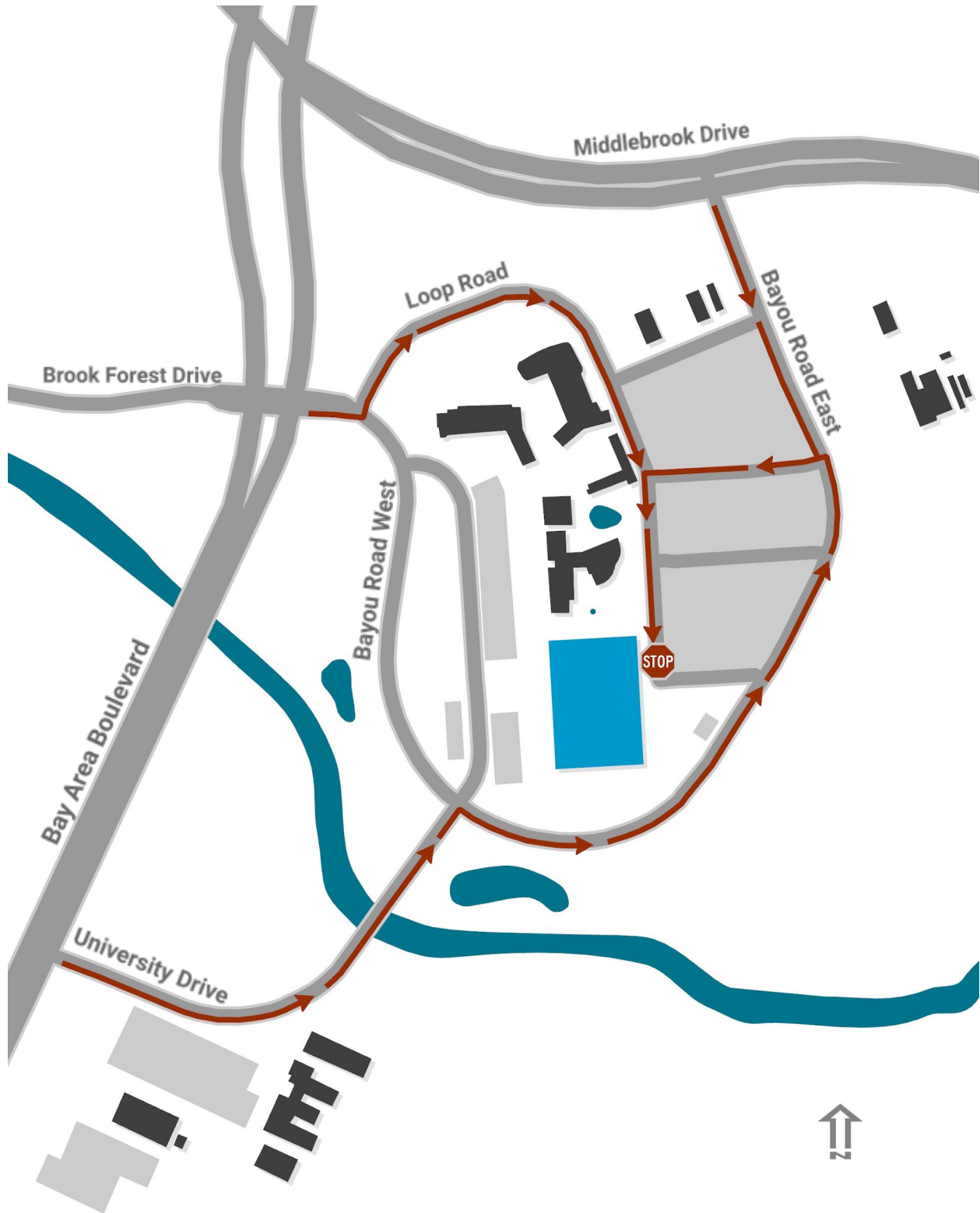

University of Houston-Clear Lake - Bayou Building
2700 Bay Area Blvd, Houston, Texas 77058

Site Map

- 1) Geocache for High School Students
- 2) Drone Display
- 3) Emergency Vehicles
- 4) Bayou Building
- 5) High School Student Drop-off
- 6) Attendee Parking
- 7) School Bus Parking

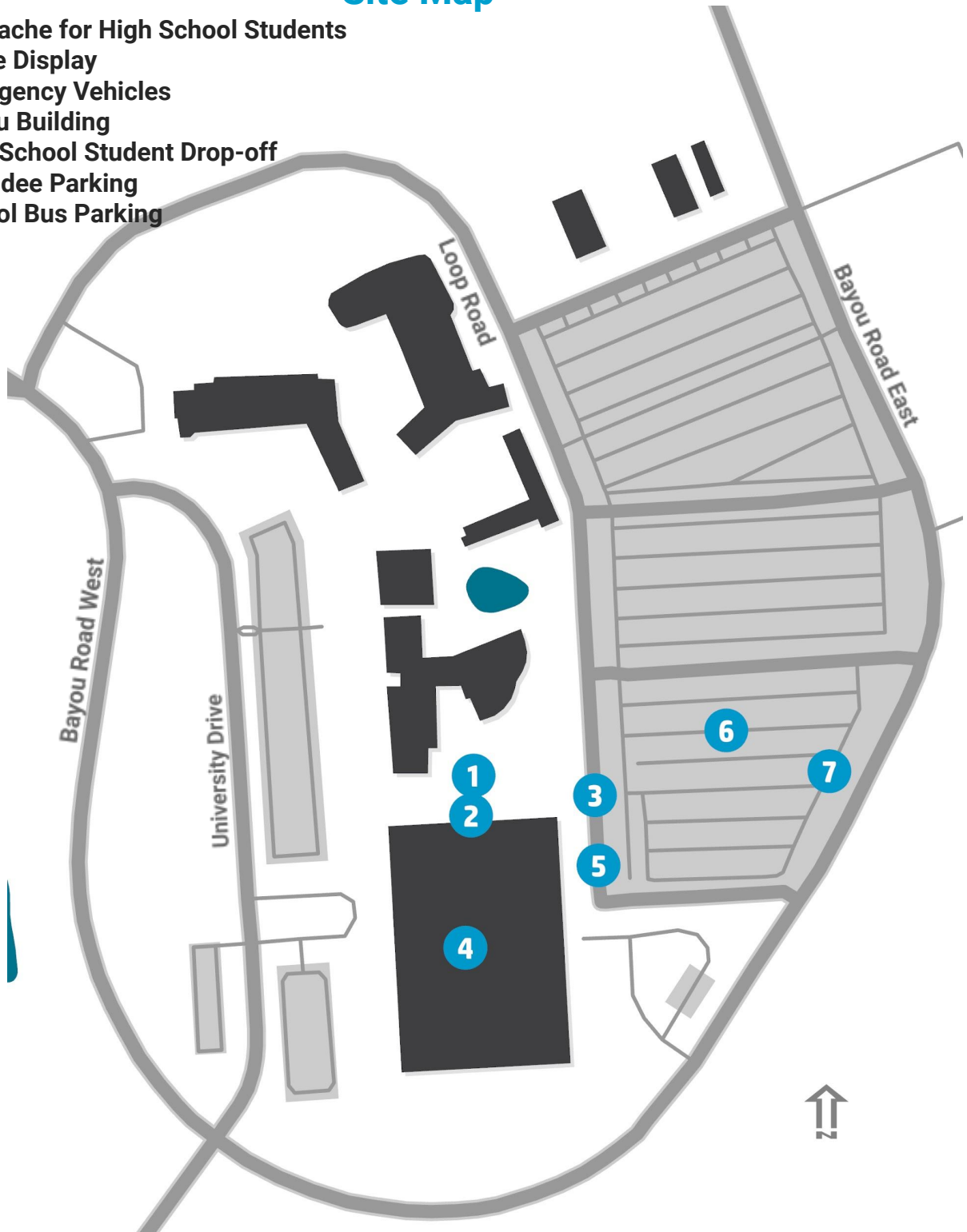

University of Houston-Clear Lake - Bayou Building
2700 Bay Area Blvd, Houston, Texas 77058

Floor Plan

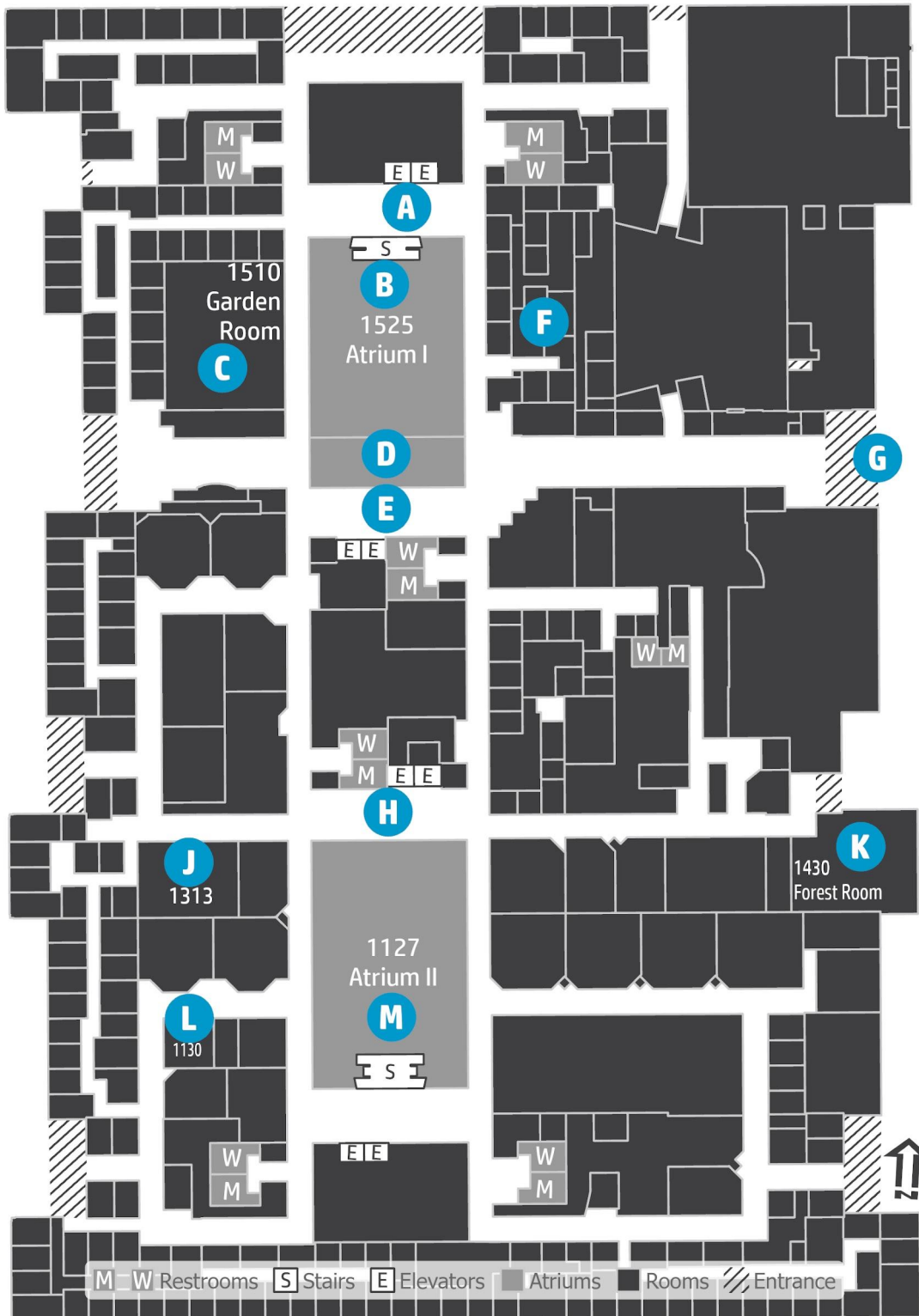

- A) Access to Theater for Morning Keynote on 2nd Floor & Lab 3606 for Pro Workshops on 3rd Floor
- B) Exhibit Area
- C) Presentations
- D) Registration Area
- E) Map Gallery
- F) Hospitality Suite
- G) Main Entrance
- H) Academic Spotlight
- J) High School Gameroom
- K) Presentations
- L) GeoMentoring
- M) Afternoon Keynote & Closing Ceremonies

Frequently Asked Questions

What day is Houston Area GIS Day?

Houston Area GIS Day is an annual event celebrating Geographic Information Systems (GIS) and geospatial technologies. It provides an opportunity for students, professionals, and the community to learn more about GIS, participate in hands-on activities, and network with fellow GIS enthusiasts.

Who is managing this event?

This event is managed by the Houston Area GIS Day Planning Committee as part of the Houston-Galveston Area Council's Geographic Data Workgroup. Visit www.HoustonAreaGISDay.org for more details.

What should I bring to the event?

Bring your registration confirmation, a government-issued photo ID, and an eagerness to learn and engage with the GIS community.

When should I arrive?

The Check-in and Registration desk will open at 8:30 am. Here's a breakdown of arrival times for different participant groups:

- **General Attendees:** Arrive in time to check-in or register, receive your badge, and event information. Doors to the facility open around 7:00 am, and attendees will start arriving by 8:30 am.
- **Exhibitors, Sponsors, GeoQuest, and Map Contest Participants:** Plan to arrive early enough to set up your booth, table, or maps. The facility doors open at 7:00 am, and we recommend having your displays ready before 8:30 am when attendees start arriving.
- **Volunteers:** Unless your team lead has provided a specific time, we ask all volunteers to check in before 8:00 am. This early arrival ensures you have time to connect with your team and assist with event setup. Volunteers are also encouraged to stay until the end to help with tear-down.

We will conduct an all-volunteer briefing between 8:00 am and 8:15 am to ensure everyone is well-informed. After checking in, feel free to make your way to the hospitality suite for coffee and breakfast.

University of Houston-Clear Lake - Bayou Building
2700 Bay Area Blvd, Houston, Texas 77058

Frequently Asked Questions (continued)

Where do I park?

We appreciate your cooperation in following these parking guidelines.

- **General Attendees:** Excluding emergency vehicle showcase participants and school buses, the designated parking area is University of Houston Parking Lot D2. Please consult the Site Map in the Event Guide for clear directions.
- **Volunteers, Exhibitors, Sponsors, and Speakers:** The designated parking area is University of Houston Parking Lot D2. Please consult the Site Map in the Event Guide for clear directions.
- **Emergency Vehicles and Discovery Bus:** Park along the curb by the Bayou Building. Please consult the Site Map in the Event Guide for clear directions.
- **School Buses:** Will receive specific guidance during student drop-off. For your convenience, please refer to the Site Map for visual guidance on parking areas.

How many attendees are expected?

We anticipate 300+ high school students and 150+ general attendees for the event throughout the day.

Will there be Wi-Fi access at the venue?

Wi-Fi access may be limited in certain areas of the venue, so please plan accordingly. It is recommended to bring personal Wi-Fi devices if needed.

Is there a dress code for the event?

Business casual attire is recommended. Dress comfortably, but remember that this is a professional event with ample networking opportunities.

Is lunch provided at the event?

Lunch is provided for high school students, teachers, presenters, exhibitors/sponsors, and volunteers. We recommend GIS professionals and college students take advantage of this opportunity to network with their peers. The planning committee will provide a list of nearby restaurants in the area for your convenience.

Frequently Asked Questions (continued)

What are the accommodations for out of town guests?

Out of town guests are expected to make their own travel and hotel accommodations. The Houston Area GIS Day Planning Committee does not reimburse for these expenses nor do they hold hotel blocks.

What are sponsors/exhibitors entitled to?

Depending on the sponsorship level, sponsors/exhibitors are entitled to a designated table space in the Exhibitor Hall, Wi-Fi access, power, as well as print/electronic use of their logo in all HAGD media. Sponsors/exhibitors, speakers, and volunteers are entitled to light refreshments in the Hospitality Suite.

How many attendees are expected?

We anticipate 300+ high school students and 150+ general attendees for the event throughout the day.

Will there be media coverage?

UHCL may have some coverage for their social media, but we do not anticipate mainstream media coverage at this event.

Is there lead retrieval for sponsors/exhibitors?

We are undecided on this at the moment, but if you are interested in lead retrieval, email houstonareagisdayorg@gmail.com with your request.

Do you have exhibitor shipping info?

Yes, you can send your exhibitor materials to the contact at UHCL below:

Dr. Jeff Lash, Geography Program Director
University of Houston-Clear Lake
SSCB 2.109.02
2700 Bay Area Boulevard, Houston, TX 77058 USA
lash@uhcl.edu | Office: 281-283-3417 | Mobile: 281-979-3343



Thursday, November 16, 2023

9am to 4:30pm CST

Frequently Asked Questions (continued)

How do I stay connected with Houston Area GIS Day?

Stay connected with us on social media. Share your experiences, tag us in your posts, and use the official event hashtags: **#HoustonAreaGISDay #HouGISday #GISDay #TxGISday**

Who can I contact if I have questions on the day of the event?

If you have any questions or need assistance during the event, please locate one of our friendly volunteers or event staff members who will be happy to help.

Please note that event details are subject to change, so stay informed by referring to the Event Guide and the event's official website.

We hope this FAQ section provides the information you need for Houston Area GIS Day. If you have additional questions, feel free to ask a volunteer or event staff member for assistance. We're here to ensure you have a great experience at the event. Enjoy your day of GIS learning and networking!

**University of Houston-Clear Lake - Bayou Building
2700 Bay Area Blvd, Houston, Texas 77058**

Acknowledgements

- Sponsors**

We are immensely grateful to our generous sponsors whose contributions have allowed us to provide this event to the community for free. Your commitment to the geospatial field and its professionals is deeply appreciated. Our event wouldn't be the same without your support.

Level	Organization	Website
GUID	iSpatial Techno Solutions	www.ispatialtec.com
LiDAR	Walter P Moore	www.walterpmoore.com
Polygon	<ul style="list-style-type: none"> AllTerra Central City of Houston CSRS Harris Central Appraisal District Nearmap NV5 Sanborn Williams 	www.allterracentral.com www.houstontx.gov www.csrsinc.com www.hcad.org www.nearmap.com www.nv5.com/geospatial www.sanborn.com www.williams.com
Line	<ul style="list-style-type: none"> Cyclomedia Eagleview EHRA Engineering Public Management Surdex 	www.cyclomedia.com www.eagleview.com www.ehra.team www.publicmgt.com www.surdex.com

- Houston Area GIS Day Planning Committee**

A special recognition goes out to the hardworking and passionate members of the Houston Area GIS Day Planning Committee. Your tireless efforts in organizing, promoting, and executing this event make it possible.

- Volunteers**

Our dedicated volunteers are the lifeblood of Houston Area GIS Day. Your time and dedication ensure that the event runs smoothly and successfully. We are grateful for your contributions.

Acknowledgements (continued)

- **Houston-Galveston Area Council's (H-GAC) Geographic Data Workgroup (GDW)**

We extend our appreciation to the H-GAC Geographic Data Workgroup, a dynamic consortium of public, private, non-profit, and educational organizations. Their ongoing commitment to the geospatial community is integral to the success of this event.

- **Our Host, University of Houston-Clear Lake (UHCL)**

A huge thank you to our host, UHCL. Your dedication and commitment to accommodating our event have gone above and beyond our expectations. Your unwavering support is instrumental in making Houston Area GIS Day a success.

We encourage all attendees to consider joining the Geographic Data Workgroup by visiting their website to find out how you can get more involved in the geospatial community.

www.h-gac.com/geographic-data-workgroup

Once again, a massive 'Thank You' to all those who've contributed to making Houston Area GIS Day a premier event in the geospatial calendar. Your dedication fuels our passion for the geospatial field.